

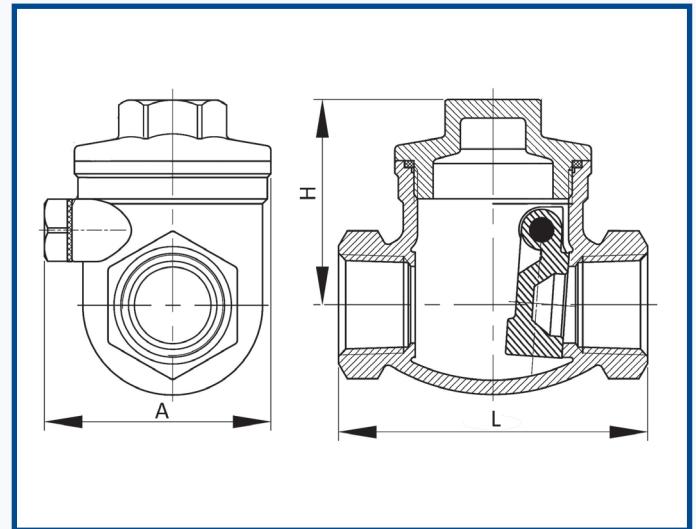

CP1009



MATERIALS

Body:	Stainless Steel CF8M
Cap:	Stainless Steel CF8M
Gasket:	PTFE
Plug:	Stainless Steel SUS316
Disc:	Stainless Steel CF8M
Gasket:	PTFE
Bolt:	Stainless Steel SUS304

CONNECTIONS

BSP Parallel: ISO228 Class A (equivalent to DIN 259)

SIZE	1/4"	3/8"	1/2"	3/4"	1"	1 1/4"	1 1/2"	2"	2 1/2"	3"	4"	5"
L (mm)	65.0	65.0	65.0	80.0	89.0	105.0	120.0	139.0				
H (mm)	43.0	43.0	43.0	50.0	60.0	66.0	75.0	80.0				
A (mm)	46.5	46.5	46.5	56.0	64.0	64.0	74.5	84.4				
Rating	CL200	CL200	CL200	CL200	CL200	CL200	CL200	CL200				
Weight (kg)	0.363	0.363	0.363	0.426	0.655	0.927	1.490	2.150				

Pressure and temperature ratings are minimum and maximum values only and actual performance will be dependant upon application.

All images on this page are for guidance only. E&OE. We reserve the right to amend specifications, prices & products without prior notification